

DRAWING MAY BE USED IN WHOLE OR PART, PROVIDED THE (IFFCO) NAME AND LOGO ARE VISIBLE IN ANY REPRODUCTION.

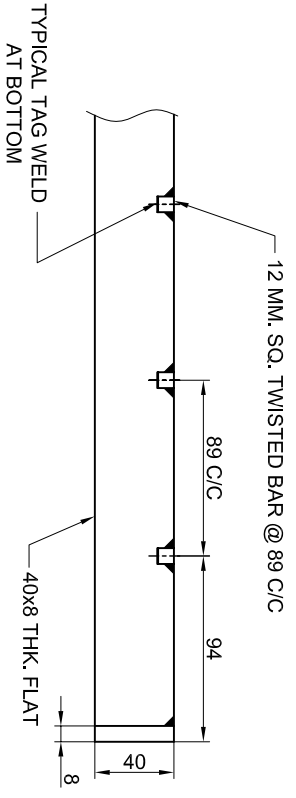
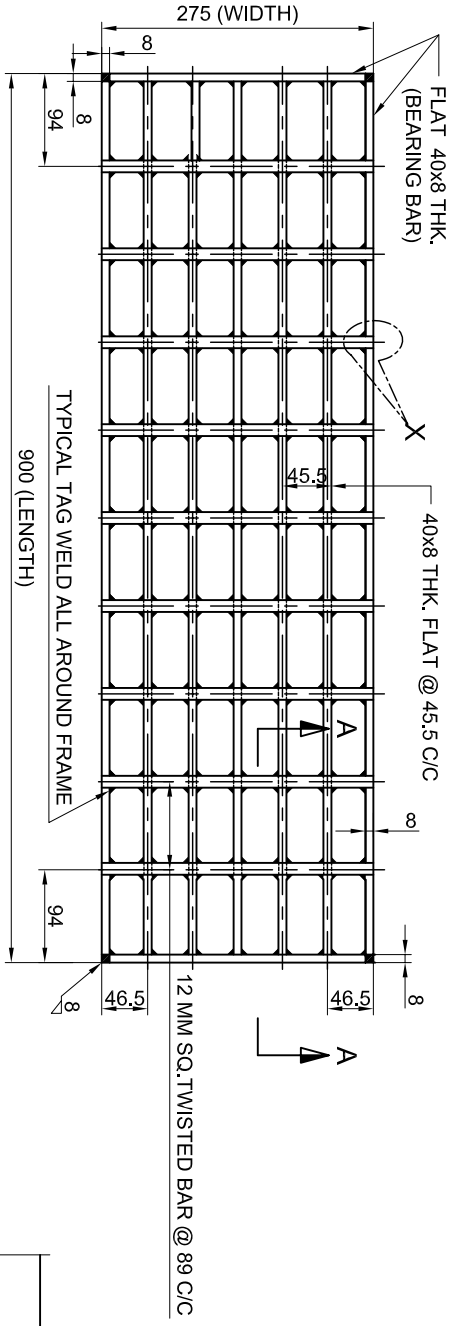

SECTION-AA
SCALE-1:2.5

MATERIAL:- MILD STEEL FABRICATION FOLLOWED BY HOT DEEP GALVANIZED WITH GALVANIZATION THICKNESS OF MINIMUM- 100 MICRONS.

NOTE:-

- 1) ALL DIMENSIONS ARE IN MM
- 2) RAW MATLS:- FLATS, SQ. BAR CONFIRM TO IS: 2062, GR-"A"
- 3) FINISH: HOT DIP GALVANISED AS PER IS: 2629 UPTO 100 MICRONS ON AS AVERAGE FLAT SURFACE.

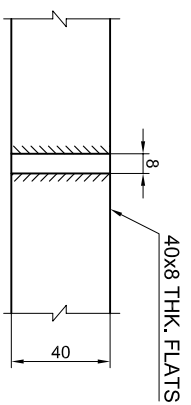

DETAIL-X
SCALE-1:2

| GRATING DETAIL | | | |
|----------------|-------|----------------|--------------------|
| LENGTH | WIDTH | MATERIAL | WT. IN Kgs. (APX.) |
| 900 | 275 | IS:2062 GR "A" | 16,780 ±5% |

| | | | |
|------------------|-------------------|--|---------|
| | | INDIAN FARMERS FERTILISER CO-OP.LTD. | |
| | | PARADEEP - ORISSA - INDIA. | |
| NAME | DATE | PLANT : U&O (PLANNING) | EMR No. |
| DRN S.SWAIN | 4.07.16 | | |
| CHD R.K.BARIK | 9.07.16 | | |
| APD D.K.NEMA | 19.07.16 | | |
| SCALE - AS SHOWN | | <p align="center">DETAILS OF TYPICAL MANUAL GRATING SIZE-(900X275) (HEAVY DUTY)</p> | |
| CODE 06DB12210 | PLANT FORM NUMBER | | |
| DRAWING NO. | SHEET OF | | |
| | REV. | | |